

Flange Adaptor PE100

**Long End for Butt and Electrofusion
Short End for Buttfusion**

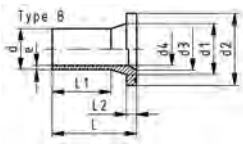

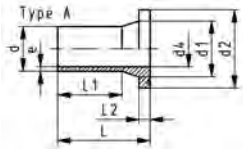

Flange adaptor PE100 SDR11 Combined jointing face: flat and serrated

Model:

- Long spigot
- For IR, butt- and electro fusion
- Suitable for flange connections to metric (from d110 also to ANSI/ASME B16.5)
- Up to d315, suitable for butterfly valve type 567/578. Above use ecoFIT adaptor for butterfly valves SDR11 (d355-d800)
- Up to d280, suitable for butterfly valve type 037/038/039. Above use ecoFIT adaptor for butterfly valves SDR11 (d315-d800)
- Gasket d20-d630: Profile flange gasket NBR No. 45 44 07, EPDM No. 48 44 07
- Gasket d710-d1000: flat gasket EPDM No. 48 40 03
- 10 bar Gas / 16 bar Water
- Type A without chamfer, Type B with chamfer

* Not suitable for butterfly valves type 037/038/039

** Not suitable for butterfly valves

	d [mm]	DN [mm]	FM	Code	Weight [kg]
	20	15	IR	753 800 006	0.022
	25	20	IR	753 800 007	0.037
	32	25	IR	753 800 008	0.056
	40	32	IR	753 800 009	0.081
	50	40	IR	753 800 010	0.119
	63	50	IR	753 800 011	0.187
	75	65	IR	753 800 012	0.314
	90	80	IR	753 800 013	0.471
	110	100	IR	753 800 014	0.706
	125	100	IR	753 800 015	0.883
	140	125	IR	753 800 016	1.348
	160	150	IR	753 800 017	1.718
	180	150	IR	753 800 018	2.035
	200	200	IR	753 800 019	2.899
	225	200	IR	753 800 020	3.208
	250	250		753 800 021	4.878
	280	250		753 800 022	4.925
*	315	300		753 800 023	7.135
**	355	350		753 800 024	10.400
**	400	400		753 800 025	14.600
**	450	500		753 800 026	24.800
**	500	500		753 800 027	27.400
**	560	600		753 800 028	40.000
**	630	600		753 800 029	42.300
**	710	700		753 800 030	56.379
**	800	800		753 800 033	72.636

	d [mm]	DN [mm]	d1 [mm]	d2 [mm]	d3 [mm]	d4 [mm]	L [mm]	L1 [mm]	L2 [mm]	e [mm]	Type
	20	15	27	45		16	85	41	7	1.9	A
	25	20	33	58		20	85	41	9	2.3	A
	32	25	40	68		26	85	44	10	3.0	A
	40	32	50	78		32	85	49	11	3.7	A
	50	40	61	88		40	90	62	12	4.6	A
	63	50	75	102		51	98	69	14	5.8	A
	75	65	89	122	66	61	125	89	16	6.8	B
	90	80	105	138	78	73	140	103	17	8.2	B
	110	100	125	158	100	90	160	114	18	10.0	B
	125	100	132	158	114	102	170	125	25	11.4	B
	140	125	155	188	127	114	200	147	25	12.7	B
	160	150	175	212	151	130	200	147	25	14.6	B
	180	150	180	212	158	147	200	170	30	16.4	B
	200	200	232	268	203	163	200	128	32	18.2	B
	225	200	235	268	210	184	200	138	32	20.5	B
	250	250	285	320	245	204	219	138	35	22.7	B
	280	250	291	320	265	229	231	144	35	25.4	B
*	315	300	335	370	300	257	239	158	35	28.6	B
**	355	350	373	430	340	290	260	176	40	32.3	B

table continued next page

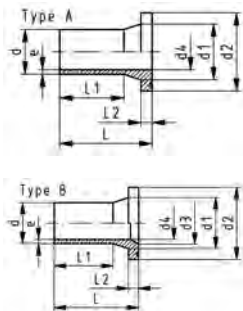

	d [mm]	DN [mm]	d1 [mm]	d2 [mm]	d3 [mm]	d4 [mm]	L [mm]	L1 [mm]	L2 [mm]	e [mm]	Type
**	400	400	427	482	385	327	290	186	46	36.3	B
**	450	500	514	585	400	368	333	195	60	40.9	B
**	500	500	530	585	440	409	350	212	60	45.5	B
**	560	600	615	685	490	458	365	230	60	50.9	B
**	630	600	642	685	545	515	385	250	60	57.3	B
**	710	700	737	800		581	400	280	60	64.5	A
**	800	800	840	905		652	400	280	65	74.0	A

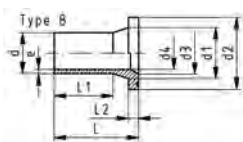
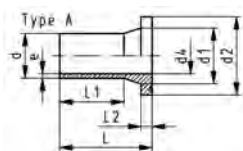

Flange adaptor PE100 SDR17/17.6 Combined jointing face: flat and serrated

Model:

- Material: PE100
- Long spigot
- For IR, butt- and electro fusion
- Suitable for flange connections to metric (from d110 also to ANSI/ASME B16.5)
- Up to d315, suitable for butterfly valve type 567/578. Above use ecoFIT adaptor for butterfly valves SDR17.6 (d355-d1200)
- Up to d280, suitable for butterfly valve type 037/038/039. Above use ecoFIT adaptor for butterfly valves SDR17.6 (d315-d1200)
- Gasket d710-d1000: flat gasket EPDM No. 48 40 03
- Gasket d20-d630: Profile flange gasket NBR No. 45 44 07, EPDM No. 48 44 07
- 5 bar Gas / 10 bar Water
- Type A without chamfer, Type B with chamfer

* Not suitable for butterfly valves type 037/038/039

** Not suitable for butterfly valves

	d [mm]	DN [mm]	FM	Code	Weight [kg]
	50	40	IR	753 800 085	0.107
	63	50	IR	753 800 086	0.168
	75	65	IR	753 800 087	0.260
	90	80	IR	753 800 088	0.367
	110	100	IR	753 800 089	0.571
	125	100	IR	753 800 090	0.684
	140	125	IR	753 800 091	1.035
	160	150	IR	753 800 092	1.342
	180	150	IR	753 800 093	1.469
	200	200	IR	753 800 094	2.297
	225	200	IR	753 800 095	2.456
	250	250		753 800 096	3.500
	280	250		753 800 097	3.714
*	315	300		753 800 098	5.470
**	355	350		753 800 099	16.200
**	400	400		753 800 100	10.300
**	450	500		753 800 101	15.800
**	500	500		753 800 102	19.995
**	560	600		753 800 103	27.500
**	630	600		753 800 104	30.000
**	710	700		753 800 105	39.376
**	800	800		753 800 106	50.759
**	900	900		753 800 107	64.202
**	1000	1000		753 800 108	79.495

	d [mm]	d1 [mm]	d2 [mm]	d3 [mm]	d4 [mm]	L [mm]	L1 [mm]	L2 [mm]	e [mm]	Type
	50	61	88		44	90	62	12	3.0	A
	63	75	102		55	106	70	14	3.8	A
	75	89	122		66	130	75	16	4.5	A
	90	105	138		79	140	103	17	5.4	A
	110	125	158		96	160	117	18	6.6	A
	125	132	158	114	110	170	125	25	7.4	B

table continued next page

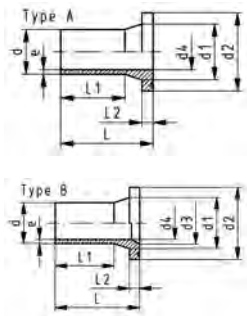

	d [mm]	d1 [mm]	d2 [mm]	d3 [mm]	d4 [mm]	L [mm]	L1 [mm]	L2 [mm]	e [mm]	Type
	140	155	188	127	123	200	147	25	8.3	B
	160	175	212	151	141	200	147	25	9.5	B
	180	180	212		158	200	170	30	10.7	A
	200	232	268	203	176	200	128	32	11.9	B
	225	235	268	210	198	200	138	32	13.4	B
	250	285	320	245	220	220	148	25	14.8	B
	280	291	320	265	246	230	154	25	16.6	B
*	315	335	370	300	277	242	166	36	18.7	B
**	355	373	430	340	312	261	179	30	21.1	B
**	400	427	483	385	352	290	196	33	23.7	B
**	450	514	585		396	333	195	60	26.7	A
**	500	530	585		440	350	212	60	29.7	A
**	560	615	685		493	365	230	60	33.2	A
**	630	642	685		555	385	250	60	37.4	A
**	710	737	800		626	400	280	50	42.1	A
**	800	840	905		705	400	280	52	47.4	A
**	900	944	1005		793	400	260	55	53.3	A
**	1000	1047	1110		881	400	260	60	59.3	A



Flange adaptor SDR11 Jointing face combination serrated/flat metric

Model:

- Material: PE100
- Conventional butt-welding according to DVS 2207 part 11
- Up to d315, suitable for butterfly valve type 567/578. Above use ecoFIT adaptor for butterfly valves SDR11 (d355-d800)
- Up to d280, suitable for butterfly valve type 037/038/039. Above use ecoFIT adaptor for butterfly valves SDR11 (d315-d800)
- Gasket d20-d630: Profile flange gasket NBR No. 45 44 07, EPDM No. 48 44 07
- Gasket d710-d1000: flat gasket EPDM No. 48 40 03

* Available starting Q3 2015

** Not suitable for butterfly valves

*** Not suitable for butterfly valves type 037/038/039

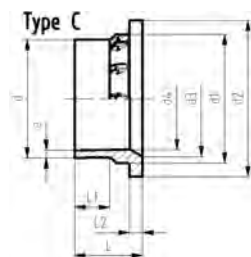
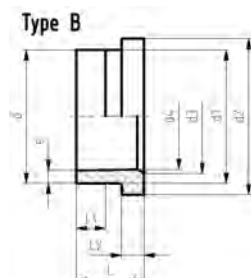
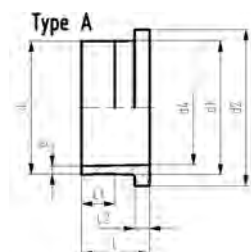

	d [mm]	DN [mm]	Code	Weight [kg]
*	20	15	753 798 306	0.016
*	25	20	753 798 307	0.034
*	32	25	753 798 308	0.046
*	40	32	753 798 309	0.067
*	50	40	753 798 310	0.098
*	63	50	753 798 311	0.157
*	75	65	753 798 312	0.258
*	90	80	753 798 313	0.347
*	110	100	753 798 314	0.471
*	125	100	753 798 315	0.517
*	140	125	753 798 316	0.780
*	160	150	753 798 317	0.973
*	180	150	753 798 318	1.077
*	200	200	753 798 319	1.734
*	225	200	753 798 320	1.772
	250	250	753 798 826	3.087
	280	250	753 798 827	3.760
**	315	300	753 798 828	4.385
***	355	350	753 798 829	5.855
***	400	400	753 798 830	8.760
***	450	500	753 798 831	14.680
***	500	500	753 798 832	13.630
***	560	600	753 798 833	19.380
***	630	600	753 798 834	16.500
***	710	700	753 798 835	21.586
***	800	800	753 798 836	28.505

	d [mm]	DN [mm]	d1 [mm]	d2 [mm]	d3 [mm]	d4 [mm]	L [mm]	L1 [mm]	L2 [mm]	e [mm]	Type
*	20	15	26	45		16.0	50.0	29	7	1,9	A
*	25	20	32	58		20.0	52.0	27	9	2,3	A
*	32	25	40	68		26.0	54.0	28	10	2,9	A
*	40	32	49	78		32.0	55.0	25	11	3,7	A
*	50	40	60	88		40.0	62.0	32	12	4,6	A
*	63	50	75	102		49.0	68.0	38	14	5,8	A
*	75	65	89	122	66	58.0	80.0	46	16	6,8	C
*	90	80	105	138	78	70.0	80.0	44	17	8,2	C
*	110	100	125	158	100	87.0	80.0	43	18	10,0	C
*	125	100	132	158	114	99.0	82.0	36	25	11,4	C
*	140	125	155	188	127	110.4	89.0	42	25	12,7	C
*	160	150	175	212	151	127.4	92.0	40	25	14,6	C
*	180	150	182	212	154	148.6	92.0	40	30	16,4	B
*	200	200	232	268	203	173.6	100.0	35	32	18,2	C
*	225	200	235	268	210	196.3	100.0	35	32	20,5	C
	250	250	285	320	245	204.0	121.0	54	35	22,7	B
	280	250	291	320	265	229.0	119.0	69	35	25,4	B
**	315	300	335	370	300	257.0	166.0	88	35	28,6	B
***	355	350	373	430	340	290.0	187.0	98	40	32,2	B
***	400	400	427	482	385	327.0	196.0	106	45	36,3	B
***	450	500	514	585	400	368.0	139.0	61	60	40,9	B

table continued next page

	d [mm]	DN [mm]	d1 [mm]	d2 [mm]	d3 [mm]	d4 [mm]	L [mm]	L1 [mm]	L2 [mm]	e [mm]	Type
***	500	500	530	585	440	409.0	138.0	62	60	45.4	B
***	560	600	615	684	490	458.0	135.0	20	60	50,8	B
***	630	600	642	684	545	516.0	135.0	40	60	57,2	B
***	710	700	737	800		581.0	120.0	20	60	64,5	A
***	800	800	840	905		655.0	120.0	18	65	72,6	A

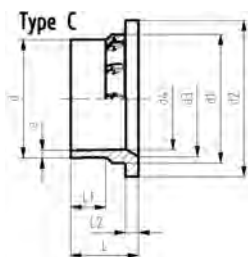
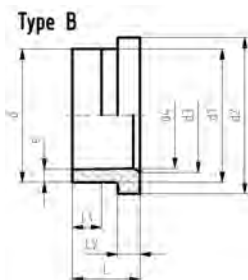
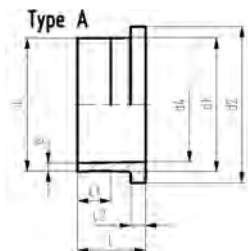

Flange adaptor SDR17.6 Joining face combination serrated/flat metric

Model:

- Material: PE100
- Conventional butt-welding according to DVS 2207 part 11
- Up to d315, suitable for butterfly valve type 567/578. Above use ecoFIT adaptor for butterfly valves SDR17.6 (d355-d1200)
- Up to d280, suitable for butterfly valve type 037/038/039. Above use ecoFIT adaptor for butterfly valves SDR17.6 (d315-d1200)
- Gasket d20-d630: Profile flange gasket NBR No. 45 44 07, EPDM No. 48 44 07
- Gasket d710-d1000: flat gasket EPDM No. 48 40 03

* Available starting Q3 2015

** Not suitable for butterfly valves

*** Not suitable for butterfly valves type 037/038/039

	d [mm]	DN [mm]	Code	Weight [kg]
*	50	40	753 798 210	0.093
*	63	50	753 798 211	0.118
*	75	65	753 798 212	0.220
*	90	80	753 798 213	0.291
*	110	100	753 798 214	0.389
*	125	100	753 798 215	0.421
*	140	125	753 798 216	0.648
*	160	150	753 798 217	0.703
*	180	150	753 798 218	0.739
*	200	200	753 798 219	1.331
*	225	200	753 798 220	1.304
*	250	250	753 798 851	2.272
*	280	250	753 798 852	2.154
**	315	300	753 798 853	3.819
***	355	350	753 798 854	4.155
***	400	400	753 798 855	7.810
***	450	500	753 798 856	10.914
***	500	500	753 798 857	9.865
***	560	600	753 798 858	14.875
***	630	600	753 798 859	12.515
***	710	700	753 798 860	15.878
***	800	800	753 798 861	20.948
***	900	900	753 798 862	29.183
***	1000	1000	753 798 863	36.209

	d [mm]	DN [mm]	d1 [mm]	d2 [mm]	d3 [mm]	d4 [mm]	L [mm]	L1 [mm]	L2 [mm]	e [mm]	Type
*	50	40	60	88		44.2	62	32	12	3,0	A
*	63	50	75	102		55.8	68	38	14	3,8	A
*	75	65	89	122		63.0	80	46	16	4,5	A
*	90	80	105	138		76.4	80	44	17	5,4	A
*	110	100	125	158		94.0	80	43	18	6,6	A
*	125	100	132	158	114	107.6	82	36	18	7,4	B
*	140	125	155	188	127	120.5	89	42	18	8,3	B
*	160	150	175	212	158	138.3	92	47	18	9,5	C
*	180	150	182	212		155.4	92	45	20	10,7	A
*	200	200	232	268	203	173.6	100	42	24	11,9	C
*	225	200	235	268	210	196.3	100	42	24	13,4	C
*	250	250	285	320	245	220.0	121	61	25	14,8	B
*	280	250	291	320	265	246.0	119	69	25	16,6	B

table continued next page

	d [mm]	DN [mm]	d1 [mm]	d2 [mm]	d3 [mm]	d4 [mm]	L [mm]	L1 [mm]	L2 [mm]	e [mm]	Type
**	315	300	335	370	300	277.0	164	86	25	18,7	B
***	355	350	373	430	340	312.0	180	100	30	21,1	B
***	400	400	427	482	385	352.0	197	110	33	23,7	B
***	450	500	514	585	400	396.0	141	64	46	26,7	B
***	500	500	530	585	440	440.0	141	67	46	29,7	B
***	560	600	615	685	430	493.0	142	60	50	33,2	B
***	630	600	642	685	545	555.0	144	71	50	37,4	B
***	710	700	737	800		626.0	120	20	50	42,1	A
***	800	800	840	905		705.0	120	18	52	47,4	A
***	900	900	944	1005		793.0	140	15	55	53,3	A
***	1000	1000	1047	1110		881.0	140	10	60	59,3	A



Adaptor for butterfly valves SDR11 Jointing face flat metric

Model:

- Material: PE100
- Conventional butt-welding according to DVS 2207 part 11
- Suitable for butterfly valves type 567/578 and 037/038/039

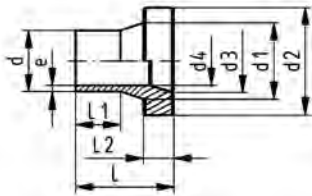

d [mm]	DN [mm]	Code	Weight [kg]	d1 [mm]	d2 [mm]	d3 [mm]	d4 [mm]	L [mm]	L1 [mm]	L2 [mm]	e [mm]
355	350	753 798 724	7.805	373	430	346	291	180	90	65	32.2
400	400	753 798 725	10.057	427	482	404	327	196	95	69	36.3
450	450	753 798 726	13.448	467	533	460	368	195	60	108	40.9
500	500	753 798 727	15.001	530	585	500	409	188	60	90	45.4
560	600	753 798 728	29.270	615	685	610	458	282	60	147	50.8
630	600	753 798 729	23.042	642	685	610	515	210	60	132	57.2
710	700	753 798 730	33.765	737	800	701	581	215	20	155	64.5
800	800	753 798 731	41.787	840	905	785	655	194	18	140	72.6



Adaptor for butterfly valves SDR17/17.6 Jointing face flat metric

Model:

- Material: PE100
- Conventional butt-welding according to DVS 2207 part 11
- Suitable for butterfly valves type 567/578 and 037/038/039

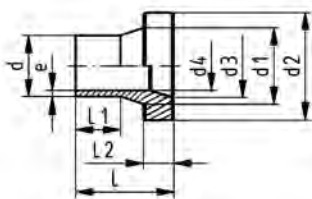

d [mm]	DN [mm]	Code	Weight [kg]	d1 [mm]	d2 [mm]	d3 [mm]	d4 [mm]	L [mm]	L1 [mm]	L2 [mm]	e [mm]
355	350	753 798 749	6.479	373	430	346	312	180	90	65	21.1
400	400	753 798 750	8.426	427	482	404	352	196	95	69	23.7
450	450	753 798 751	9.570	467	533	460	396	195	60	70	26.7
500	500	753 798 752	8.263	530	585	500	440	144	60	47	29.7
560	600	753 798 753	17.307	615	685	610	493	227	60	92	33.2
630	600	753 798 754	12.122	642	685	610	555	149	60	71	37.4
710	700	753 798 755	21.505	737	800	701	625	175	20	105	42.1
800	800	753 798 756	21.841	840	905	785	705	142	18	74	47.4
900	900	753 798 757	34.187	944	1005	890	793	189	15	104	53.3
1000	1000	753 798 758	43.733	1047	1110	994	881	204	10	124	59.3
1200	1200	753 798 759	106.295	1256	1330	1860	1057	377	160	126	71.2